

USER MANUAL

REQUIRED TOOLS AND MATERIALS

Materials:

- TN plasterboard screws
- Polyurethane adhesive in foam or gypsum glue (i.e. Ceresit Ct84 or Knauf Perlfix)
- Joint compound for plasterboards (i.e. Knauf Uniflott)
- Acrylic for sealing edges (i.e. Soudal Acryl)
- Wall plugs (suitable for your ceiling/wall type)

Tools:

- Drill driver
- Concrete drill
- Taper knife
- Level
- Measuring tape
- Pencil
- Sandpaper
- Wood saw
- Spatula

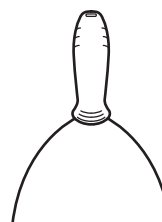
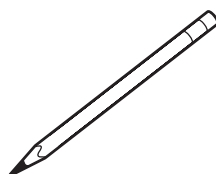
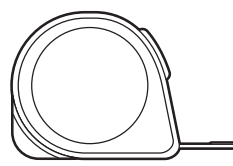
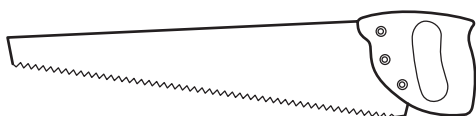
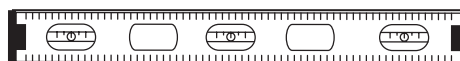
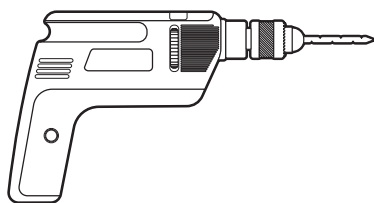

Step 1

Installation setup

Using a pencil and a tape measure, mark out the location of the moulding. Remember to keep the proper spacing for the curtain rod or curtain rail.

Next, mark the places where you will screw in the mounting plates. The spacing between the plates is a maximum of 1,2m. It's a good idea to put the plate on the joint of the mouldings - it makes it easier to align the edges.

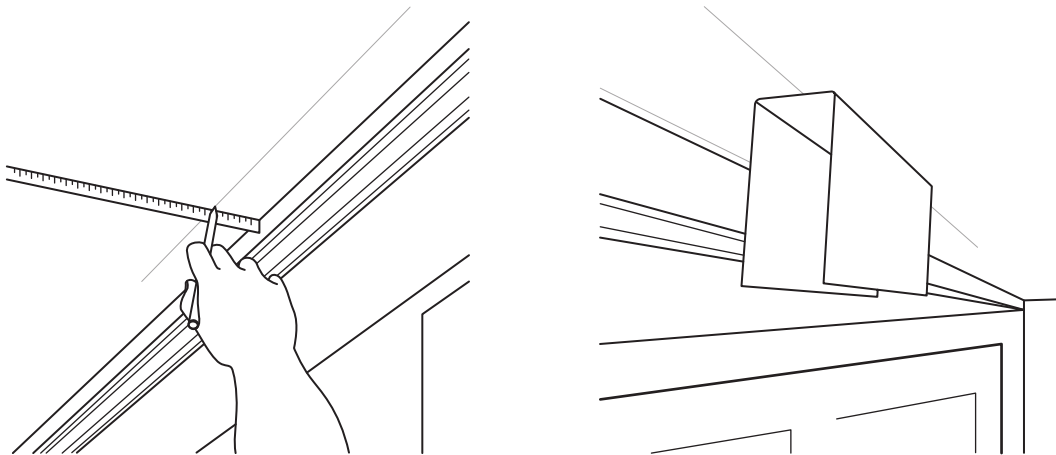

Step 2

Install moulding

Sand the cut edges gently, this will make it easier to putty later on.

Apply polyurethane or gypsum glue to the gap with styrofoam.

Then push the moulding on the mounting plates, so that the plate is between the styrofoam and the plasterboard.

Finally, screw the moulding to the mounting plate.

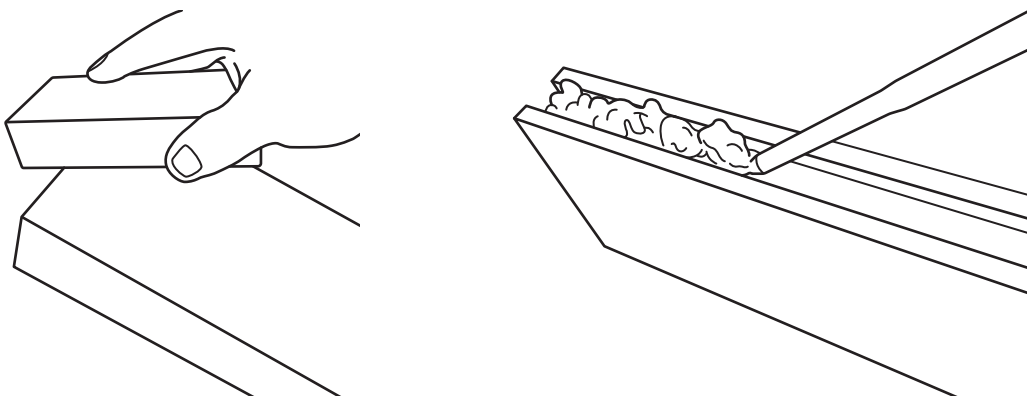

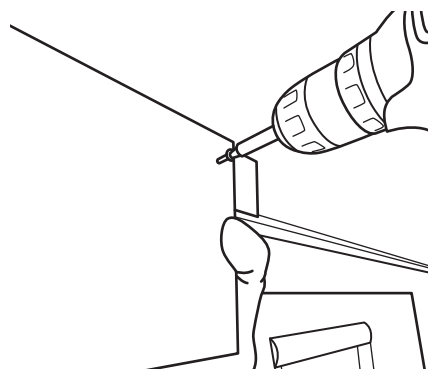
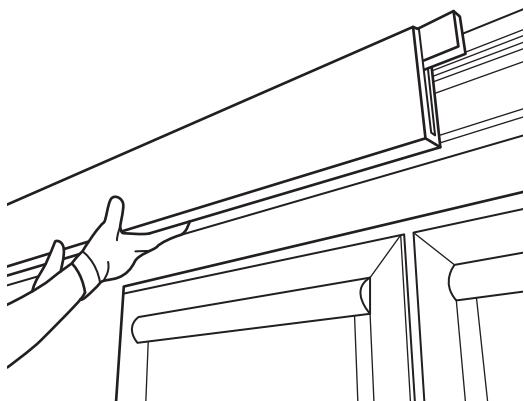

Step 3

Install second moulding

The next moulding is installed in the same way as in the previous steps.

It is a good idea to put a little glue on the joint of the moulding to stiffen the joint.

If you need to cut to size use a wood saw.

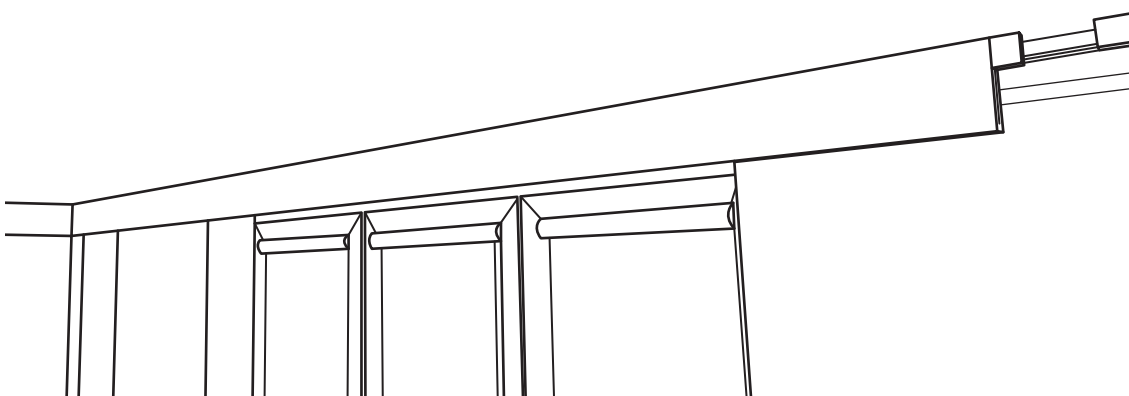
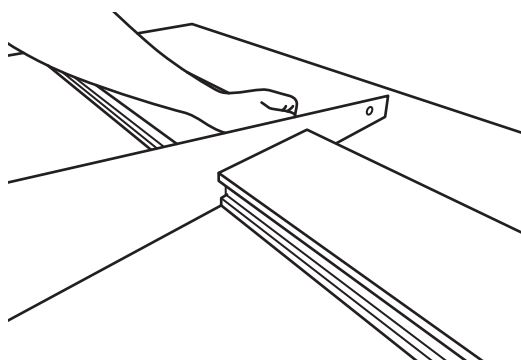
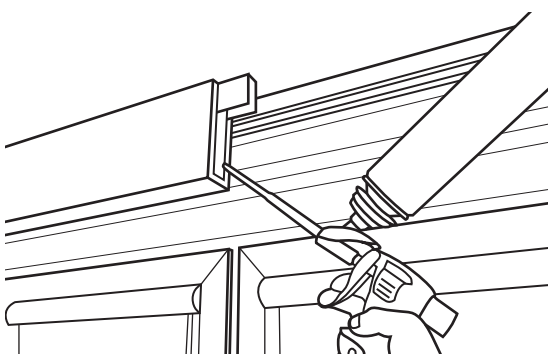

Step 4

Filling joints and edges

Once the adhesive has set, you can proceed to puttying the joints. Use gypsum board joint compound (we recommend Knauf Uniflott). Apply evenly with a spatula to the joints and the screw heads. When dry, sand with sandpaper.

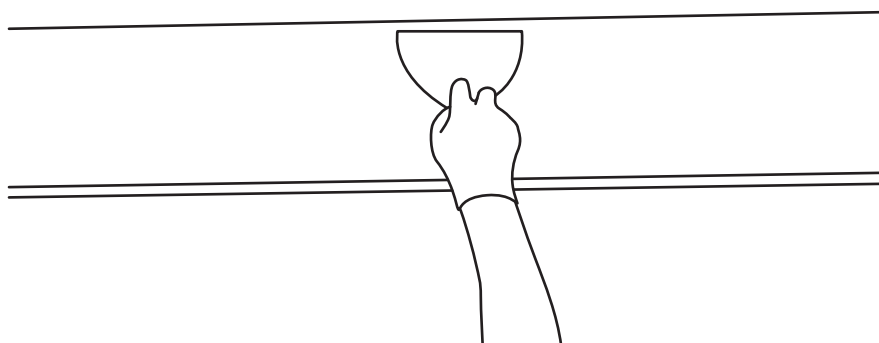

Step 5

After the joint compound is dry, sand the joint with sandpaper. Apply acrylic to the joints of the moulding with the wall and the ceiling. After drying, the moulding is ready for painting!

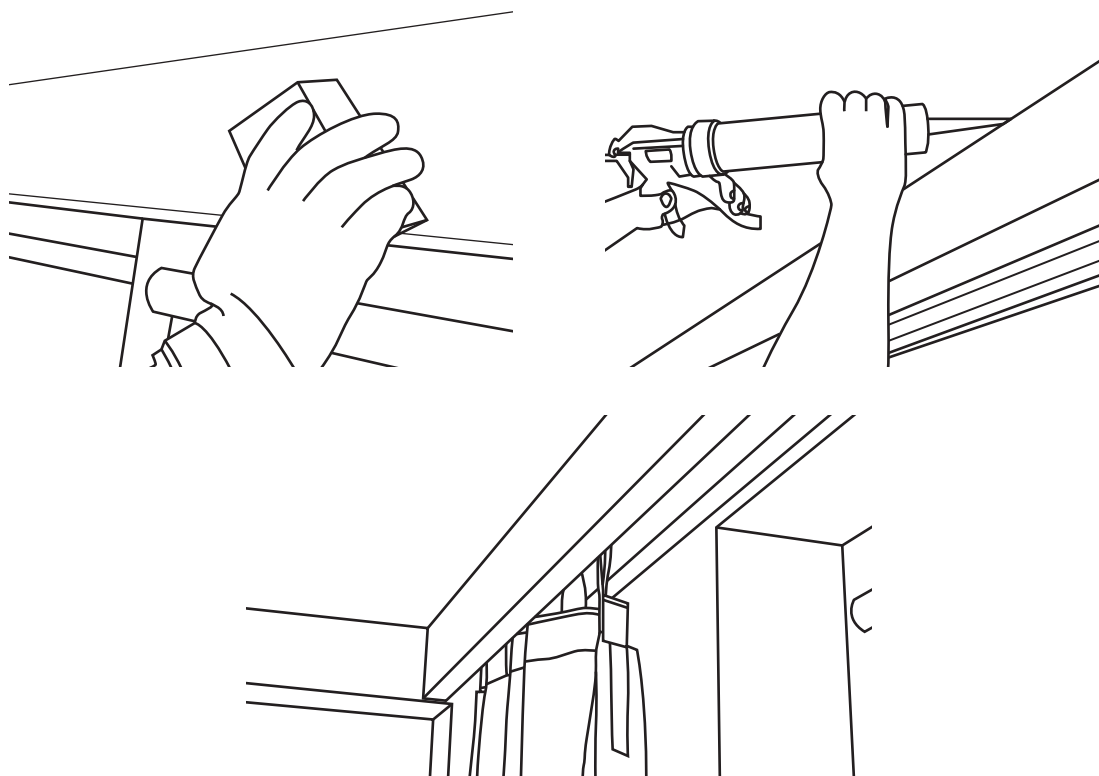

REMARKS

When performing assembly works, follow technical guidelines of the manufacturers of materials used. Such information can be found on the material packaging, and in their MSDS sheets. If in doubt, consult the provider of the materials.

The above data, recommendations, and guidelines rely on our best knowledge, studies and experiments, and have been provided in good faith, according to the principles applicable at our Company. The proposed methods of procedure are considered generally applicable, but ever user of the material must make sure in all possible ways, including checks of the final product in appropriate conditions, about the fitness of materials supplied for the intended purposes. Our Company cannot be liable for any losses incurred as a result of incorrect or wrong use of its materials.